

Moff Band Quick Start Guide

Download



About Moff Applications, you can search for "Moff" by inputting it in the Application Store.

How to setup Moff Band : please refer to the following the WEB site.

► <http://support.moff.mobi>

Installing Moff Band's battery

Remove the battery cover.

- 1 Check the groove of the battery cover is fixed.
- 2 Open the battery cover by rotating it about 10 degrees clockwise to open using a coin or a screwdriver.
- 3 Remove the battery cover. Turn the battery cover clockwise till the 3 metal legs of the acover are aligned with the 3 holes. Then flip the device over and tap the battery cover slightly, the cover should drop if it's properly aligned.

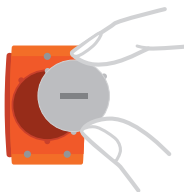

- 4 When inserting the coin battery (CR2032), make sure that the positive (+) is facing in the correct direction.

- 5 Attach the cover of coin battery. Align the groove of Moff Band with the tab of the battery cover.



- 6 Rotate the battery cover about 10 degrees counterclockwise to close using a coin or a screwdriver.



(NOTE)

This is a battery cover with a rubber part. After checking the battery cover with the rubber part, attach the battery cover to Moff.

When you use a coin or a screwdriver, please use the right size. Do not push it with more than necessary force. Doing so might damage it.

If the sound is not output

- Please increase the volume
- Please make sure that the silent switch on the smartphone side is turned off.



Operating Moff Band

Moff Band operates with the button to turn ON or OFF.

- 1 From the power-off state, push the button for 0.2 sec. briefly, and the green LED will light for 3 sec. and will off. The power is ON.

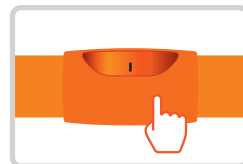

2

To make sure that the power is ON : From the power-on state, push the button briefly for 0.2 sec. LED will not light.



(Note) LED will not light in the state that is not the battery.

- 3 From the power-on state, press and hold the button for 3 sec., and the red LED will light. If the button is released, the power is OFF.

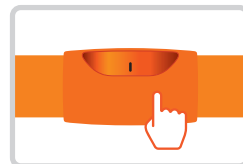

About Moff Applications

Start Moff application. Register Moff Band into Moff application according to directions of the screen. Moff Application list screen is displayed. Let's Enjoy!

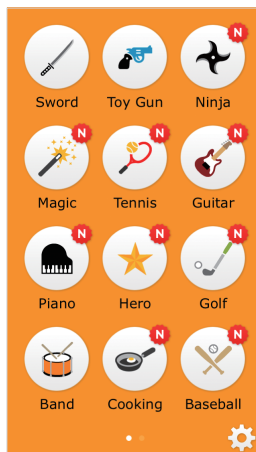

Wearing Moff Band

- 1** Attach a silicon cover to main body.

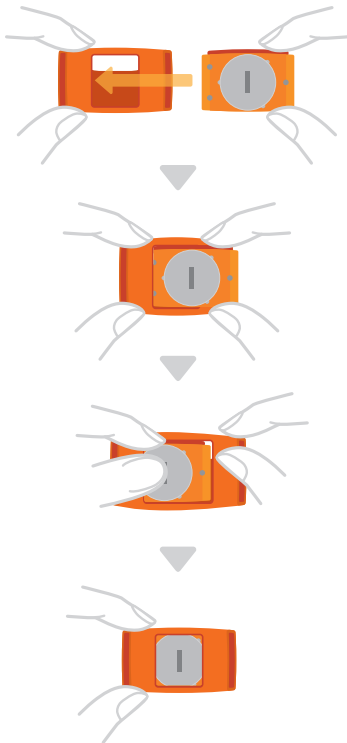

- 2** Run the wrist band to the silicon cover.

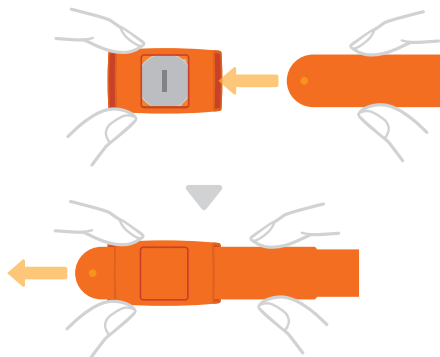

- 3** Put the wrist band on your dominant arm (you are right or left handed). Then the button is in the direction of the fingertip side.

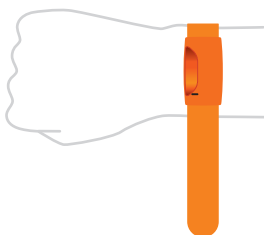

(NOTE)

about your dominant arm (right or left handed), this means your arm used for everyday activities like swinging a racket, throwing a ball, and so on.

Help

Please refer to "<http://support.moff.mobi/>" for troubleshooting and the support about Moff Band.

If you have any questions, please email us.

► support@moff.mobi

Important information about safety

Please read the indication indicated here, follow these.

- Please do not open a Moff Band. When the substance contained in a product is processed or discarded by an unsuitable method, it causes harm to the human body and the environment.
- Please do not convert Moff Band.
- Please do not use an abradant for cleaning of Moff Band.
- Please do not put Moff Band into a dish washer, a washing machine, and a drier.
- Please do not expose Moff Band to a super-high temperature or a super-cryogenic temperature.
- Please use Moff Band in neither a sauna nor a mist room.
- Please do not use Moff Band underwater.
- Please do not expose Moff Band to a sunlight for a long time.
- Please do not put Moff Band near fire.
- Do not dispose of Moff Band as "Combustible trash".
- Please do not decompose Moff Band. There are no fixable parts.
- Please do not throw or step on Moff Band.
- Please keep Moff Band out of the reach of children to prevent accidental ingestion and choking.
- Make sure that **all** players using the Moff Band are wearing the band and that it has been tightened.
- Make sure that furniture, objects and people are out of the play area so you don't accidentally bump into them while playing.

Note about the battery

According to the instructions contained in the operating instructions, please change the battery, please do not use except the coin battery (CR2032). Please take care about the direction of an electrode. The battery life will be changed depending on our environmental temperature, the situation, the aging, the quality, and the characteristics.

Operating temperature range will be different depending on the battery. Please use the battery after confirming the specification of the battery to be used.

Warranty

For details on warranty, see <http://support.moff.mobi/warranty/>

Precautions about regulation

FCC: Federal Communications Commission Statement

This device complies with part 15 of the FCC Rules. Operation is subject to the following two conditions: (1) This device may not cause harmful interference, and (2) this device must accept any interference received, including interference that may cause undesired operation.

FCC CAUTION

Changes or modifications not expressly approved by the party responsible for compliance could void the user's authority to operate the equipment.

Note: This equipment has been tested and found to comply with the limits for a Class B digital device, pursuant to part 15 of the FCC Rules. These limits are designed to provide reasonable protection against harmful interference in a residential installation. This equipment generates, uses and can radiate radio frequency energy and, if not installed and used in accordance with the instructions, may cause harmful interference to radio communications. However, there is no guarantee that interference will not occur in a particular installation. If this equipment does cause harmful interference to radio or television reception, which can be determined by turning the equipment off and on, the user is encouraged to try to correct the interference by one or more of the following measures:

- Reorient or relocate the receiving antenna.
 - Increase the separation between the equipment and receiver.
 - Connect the equipment into an outlet on a circuit different from that to which the receiver is connected.
 - Consult the dealer or an experienced radio/TV technician for help.
- This transmitter must not be co-located or operated in conjunction with any other antenna or transmitter.

This equipment complies with FCC radiation exposure limits set forth for an uncontrolled environment and meets the FCC radio frequency (RF) Exposure Guidelines. This equipment has very low levels of RF energy that are deemed to comply without testing of specific absorption ratio (SAR).

FCC ID: 2ABXBVMCN5103

EU

Hereby, Moff, Inc., declares that this Moff Band model b001 is in compliance with the essential requirements and other relevant provisions of Directive 1999/5/EC.

